

# ASSA 8460

Cam Lock

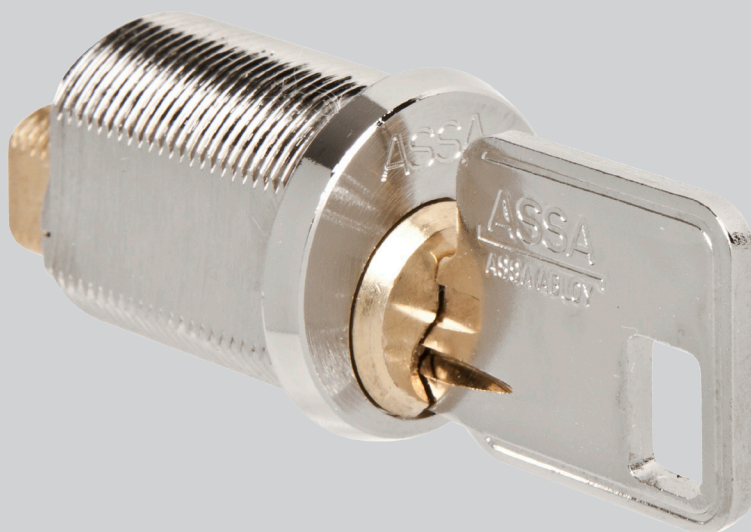

#### Performance

6-pin camlock for material thickness up to 20 mm. Cylinders and keys of nickel plated brass. Large selection of 3 mm thick catches. Can be master keyed.

#### Function

The key turns 90° and can only be removed in locked position. Right hand turning as standard and left hand is available on request.



ASSA ABLOY, the global leader  
in door opening solutions.



# ASSA 8460

## Cam Lock

### Dimension (mm)

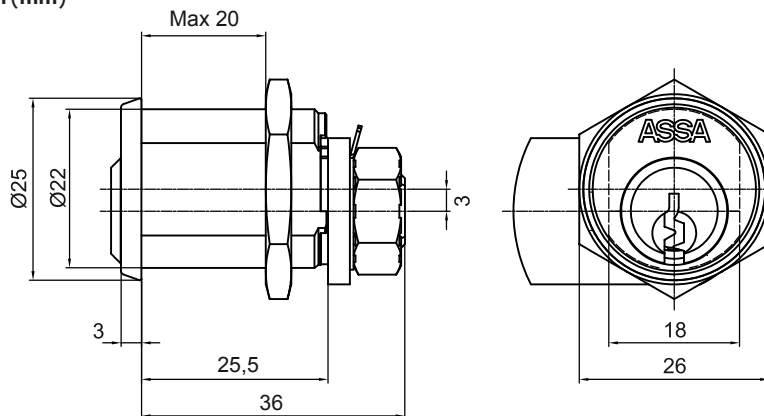

Part number:

492815000002RH With keys

492870000002RH Without key

### Hole preparation

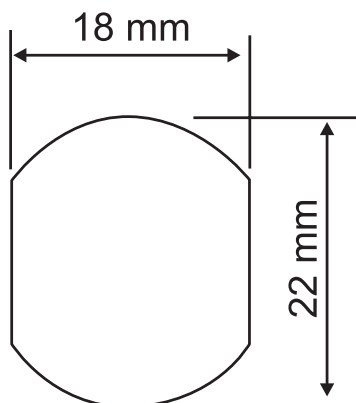

ASSA ABLOY, the global leader in door opening solutions, dedicated to satisfying end-user needs for security, safety and convenience.

ASSA OEM AB  
P.O. Box 371  
SE-631 05 Eskilstuna  
Sweden

phone +46 (0)16 17 70 00  
fax +46 (0)16 17 70 49

Customer support:  
phone intl. +46 (0)16 17 70 00  
kundservice.etuna@assaoem.se

www.assaoem.se

Included in part no: 492815 000 002

Part	Part no.	Material	Finish
2 keys	492819 000 002	Brass	Nickel plated
Large nut	490610 000 057	Steel	Zinc plated
Small nut	491439 000 057	Steel	Zinc plated
Stop washer	492367	Brass	Nickel plated
Locking washer	490246 000 057	Steel	Zinc plated

### Keys

Keys together with lock 492366 000 000

Extra keys 492373 000 000

### Notes

Cylinder house: Nickel plated brass

Cylinder: Brass

Accessories see data sheet "Accessories"

Catches see data sheet "Catches"

Spare parts see data sheet "Spare Parts"